

Application for Provisional Premises Licence

Applicant	Premises
1. Select Service Partner UK Limited	McIntyres Bar Prestwick International Airport Prestwick
Retail Sale of Alcohol (On Premises)	Monday to Saturday 08:00* – 00:30 Sunday 08:00* – 00:00
Retail Sale of Alcohol (Off Premises)	Every day 10:00 – 22:00 *Outwith Board guidelines

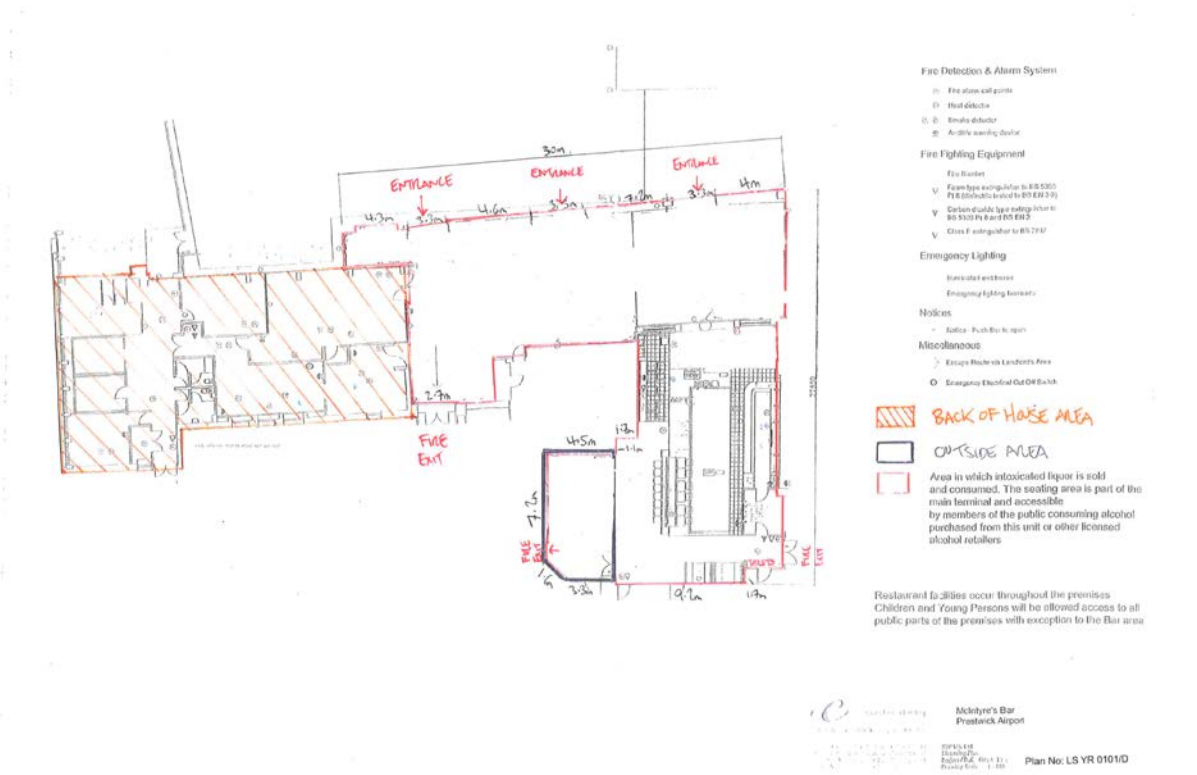

**REPORT BY THE CLERK TO THE
LICENSING BOARD OF 15th JUNE 2022**

**SUBJECT: APPLICATION FOR
PROVISIONAL PREMISES LICENCE**

**MCINTYRES BAR
PRESTWICK INTERNATIONAL AIRPORT
PRESTWICK**

APPLICANT

**SELECT SERVICE PARTNER UK LIMITED
JAMESTOWN WHARF
32 JAMESTOWN ROAD
LONDON
NW1 7HW**

APPLICATION REPORT

1 Background:

An application for a provisional premises licence for premises which are situated on the landside concourse of Prestwick Airport. The premises were previously licensed, but the licence was surrendered in September 2020.

The core hours sought are 08.000- 00:30 daily for on sales and 10:00 -22:00 daily for off sales.

The applicants intend to provide: - restaurant facilities, bar meals, receptions, club meetings, recorded music, live performances, gaming, indoor/outdoor sports, televised sport, and outdoor drinking facilities.

Children and Young Persons will be allowed access to the premises during opening times. Children must be accompanied by a responsible adult at all times. Children aged under 14 will not be allowed access to the bar area.

The capacity requested is 303 and this has been agreed with Building Standards.

2. Reports

There have been no objections or representations.

A Section 50 Certificate from Planning has been lodged along with the application, and further section 50 certificates will be required from Building Standards and Environmental Health if the provisional licence is granted.

The applicant has provided a disabled access and facilities statement -Appendix 1.

The applicant has also provided details of how it will meet the licensing objectives – Appendix 2

The hours sought for on sales are outwith Board policy which states at 7.2 “The Board considers that the maximum trading hours to be enjoyed by any premises shall not exceed fourteen and a half continuous hours. The earliest opening time normally permitted will be 10am”. However, the premises previously enjoyed similar hours to those requested.

Board Options

The Board should establish what it considers to be locality. In the past the airport has been treated as the locality. There are no other licensed premises landside . (For the avoidance of doubt, the facilities which are airside, ie after security controls, and to which only passengers have access, are exempt premises and do not require a licence.)

The Board must, in considering and determining the application consider whether any of the grounds for refusal applies and-

The Board must, in considering and determining the application consider whether any of the grounds for refusal applies and-

- (a) if none of them applies, the Board must grant the application, or
- (b) if any of them applies, the Board must refuse the application.

The grounds for refusal are—

- (a) that the subject premises are excluded premises,
- (b) that the application must be refused under section 25(2), 64(2) or 65(3),
- (c) that the Licensing Board considers that the granting of the application would be inconsistent with one or more of the licensing objectives,
- (d) that, having regard to—
 - (i) the nature of the activities proposed to be carried on in the subject premises,
 - (ii) the location, character and condition of the premises, and
 - (iii) the persons likely to frequent the premises,
 the Board considers that the premises are unsuitable for use for the sale of alcohol,
- (e) that, having regard to the number and capacity of—
 - (i) licensed premises, or
 - (ii) licensed premises of the same or similar description as the subject premises,
 in the locality in which the subject premises are situated, the Board considers that, if the application were to be granted, there would, as a result, be overprovision of licensed premises, or licensed premises of that description, in the locality.

Person to Contact:

Karen Briggs
 Depute Clerk
 County Buildings
 Wellington Square, Ayr
 Telephone (01292) 617687
 Date 30th May 2022

SCHEDULE 6

Regulation 7

DISABLED ACCESS AND FACILITIES STATEMENT

*Licensing (Scotland) Act 2005, section 20(2)(b)(ia)***Question 1****Disabled access and facilities**

1(a)	Is there disabled access to the premises	YES / NO*
1(b)	Do you have facilities for those with a disability	YES / NO*
1(c)	Do you have any other provisions available to aid the use of the premises by disabled people	YES / NO*
*Delete as appropriate		

If you have answered Yes to any of the questions above please complete, as appropriate, the following sections.

Question 2**Disabled access to, from and within the premises**

Please provide clear and detailed description of how accessible the premises are for disabled people. e.g. ramps, accessible floors, signage.

The premises are located at ground level within Prestwick Airport meaning there is unrestricted access.

Question 3

Facilities available

Please describe in detail the facilities provided for disabled people. e.g. disabled toilets, lifts, accessible tables.

Accessible WCs are available throughout the Airport.

Tables are accessible for ease of use and chairs can be moved to allow for room for wheelchair users.

Question 4

Other provisions

Please provide details of any other provisions made to aid the use of the premises by disabled people. e.g. assistance dogs welcome, large print menus.

Staff will assist disabled customers if required.

Licensing Objectives

Select Service Partner UK Limited - McIntyres, Prestwick Airport

Protecting Children from Harm

- No alcohol lines appealing to children or young persons will be available.
- There is CCTV coverage at the premises and 3 personal licence holders, with 1 on shift at all times.
- Staff will undergo Licensing training every 6 months
- Challenge 25 will be in operation.
- Children and young persons will be allowed access to the premises during opening times. Children must be accompanied by a responsible adult at all times.
- Children and young persons will be allowed access to all public parts of the premises. Children aged under 14 will not be allowed access to the bar area.

Protecting and Improving Public Health

- Non-alcoholic bottled lager will be available
- Free tap water is available on request
- Staff will undergo Licensing training every 6 months
- Staff will undergo Health and Food Safety training every 6 months

Preventing Crime and Disorder

- There is CCTV coverage at the premises
- Company Policy is to refuse alcohol sales if it is considered necessary and the staff are not comfortable making the sale whether that is because the customer is aggressive, intoxicated or questionable.
- There will be 3 personal licence holders, with 1 on shift at all times.
- Staff will undergo Licensing training every 6 months
- Staff undergo General Aviation Security training

Preventing Public Nuisance

- There is CCTV coverage at the premises and 3 personal licence holders, with 1 on shift at all time.
- Staff will undergo Licensing training every 6 months

Securing Public Safety

- There is CCTV coverage at the premises.
- All staff are trained on Health and Safety legislation including training on how to recognise dangers and the correct procedures for dealing with them.
- Staff receive General Aviation Security training
- Staff will undergo licensing training every 6 months