

Agenda Item no 8.

Gambling Act 2005

Application for Unlicensed Family Entertainment Gaming Machine Permit

Applicant	Premises
Genda Europe Limited	Craig Tara Holiday Park (Lighthouse) Dunure Road Ayr KA7 4LB
Genda Europe Limited	Sundrum Castle Holiday Park Main Arcade Coylton KA5 5JH
Genda Europe Limited	Craig Tara Holiay Park Dunure Road Ayr KA7 4LB

GENERAL NOTES
 All Leisure Concepts drawings to be read in conjunction with Architect, Structural Engineer, M&E Consultants and all other specialist contractors/ suppliers drawings for fit out area.
 Drawing to be read in conjunction with all other Leisure Concepts drawings for area.
 All works to be carried out by recommended installation contractors to manufacturers' instructions/ recommendations.
 All work should comply with BS Codes of Practice and all Statutory Requirements.
 All dimensions are in millimetres unless stated otherwise.
 Set out to be discussed with Interior Designer prior to construction.
 The Shop Fitter and Contractor must familiarise himself with the site and measure all areas affecting his work. All dimensions to be verified on site prior to manufacture of any artefact or works, on or off site.
 Samples of all finishes showing realistic interpretation of material, texture, colour, reflectivity and quality of finishing to be submitted to the Designer for approval, prior to manufacture.
 All softwood units and panelling to be in good quality, relatively knot-free softwood, clear and better, unsorted, with sheet materials faced in veneer to provide a good quality finish when varnished.
 All edge trims and mouldings to be in solid wood (unless otherwise specified) and finished to match Contractor to ensure that timber is pre-treated as necessary to comply with F.R requirements of Building Control and all finishes to achieve good quality appearance as specified by architect.
 Carcassing should be non-combustible or be certified as minimum Class 1 Surface Spread of Flame, in accordance with BS476 Part 7 1971 or 1987.
 Lighting and small power requirements shown are not necessarily the total requirements. Service areas, toilets, air handling, Building Heig requirements, specialist contractors' items e.g stage power is to be specified by others.
 The Contractor must confirm total requirements with the M&E Consultant and specialist contractors.
 All electrics to comply fully with 17th Edition and latest updates & amendments as determined by NICEIC.

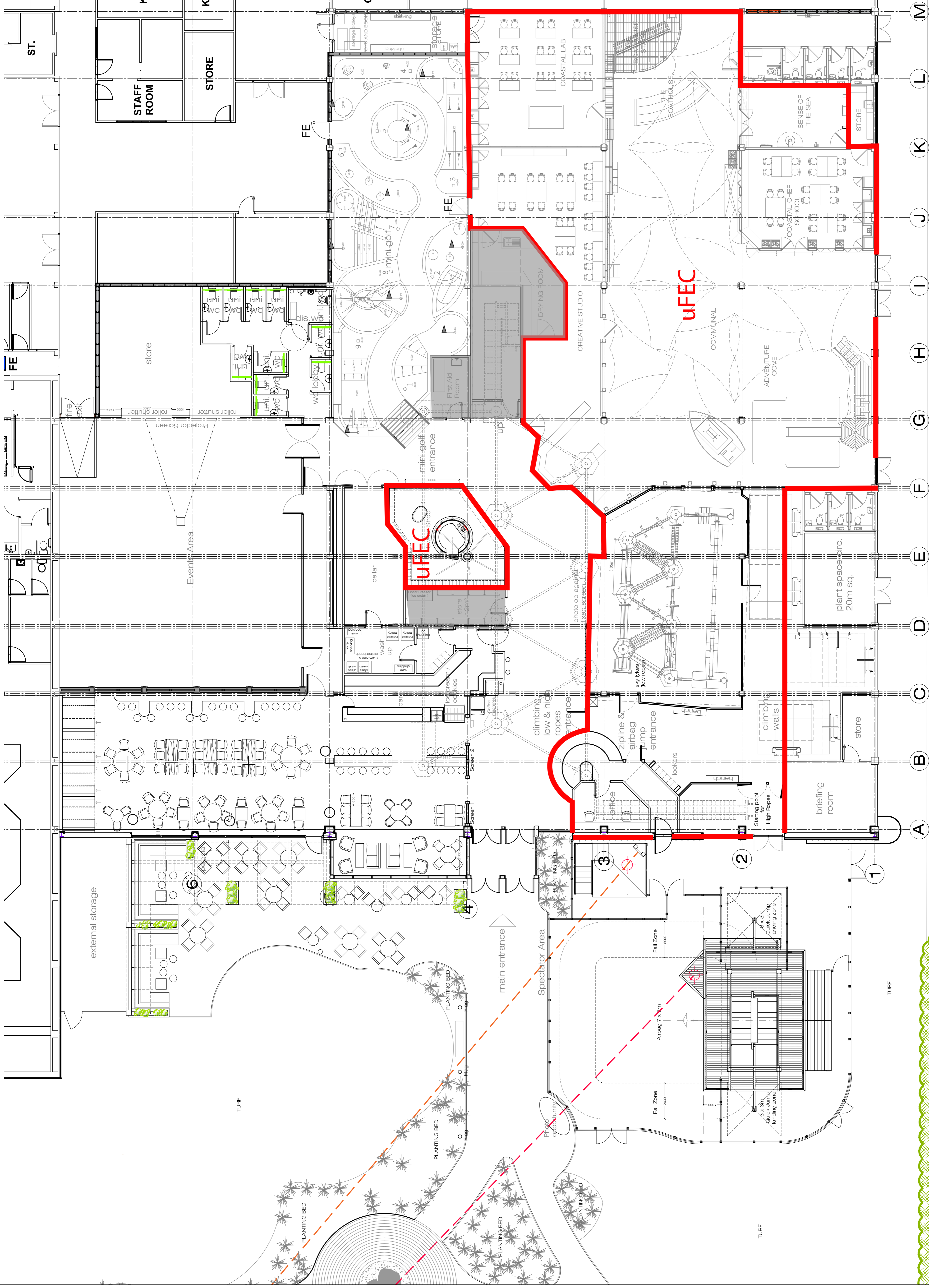

PRINT DATE: 10 May 2019

CONSTRUCTION

R	24.04.19	General Update/ Stairs removed from main road	EV
Q	25.02.19	Play Village layout updated	EV
P	28.01.19	General layout updated	JB
N	04.12.18	JVC layout revised (numbers increased)	EV
M	26.11.18	Jump Tower position changed / low ropes fence	EV
L	07.11.18	CONSTRUCTION ISSUE	EV
K	25.10.18	4 x 4 track omitted / booth seating omitted / Bar revised / Coffee machines added / gate swings revised	EV
J	17.10.18	Bar revised / Ice Cream Fridge added	EV
I	03.10.18	Adventure Cove seating revised	EV
G	13.09.18	Stairs at Jump tower set increased / general update	EV
F	28.08.18	Bar Seating area extended / general layout update	EV
E	25.07.18	Climbing, Bar and Air Drop areas amended	AMM
D	16.07.18	Plan revised to show updated climbing walls	JB
C	13.07.18	Plan revised to show updated activities layout	JB
B	27.06.18	Plan revised to show updated bar area & furniture layout	JB
A	27.05.18	Plan revised to show updated activities	JB

Rev (Date) Description

leisureconcepts
 the trading estate
 the trading estate
 common lane
 telephone: +44 (0)1926 851454 fax: +44 (0)1926 851776
 email: admin@leisureconcepts.co.uk
 client
 HAVEN - CRAIG TARA
 project
 Turnberry Phase 2
 title
 Proposed Plans - GF Plan
 scale
 1:100 @ A1
 date
 Feb 2018
 drawing no
 2229.3.01R
 drawn by
 JB
 © this drawing and all the information herein is copyright and no part of it may be reproduced without the prior written consent of Leisure Concepts. Wherever the drawings are given they are to be accepted in preference to scaled sizes, the contractors are responsible for verifying all dimensions shown hereon before putting any affected work in hand.

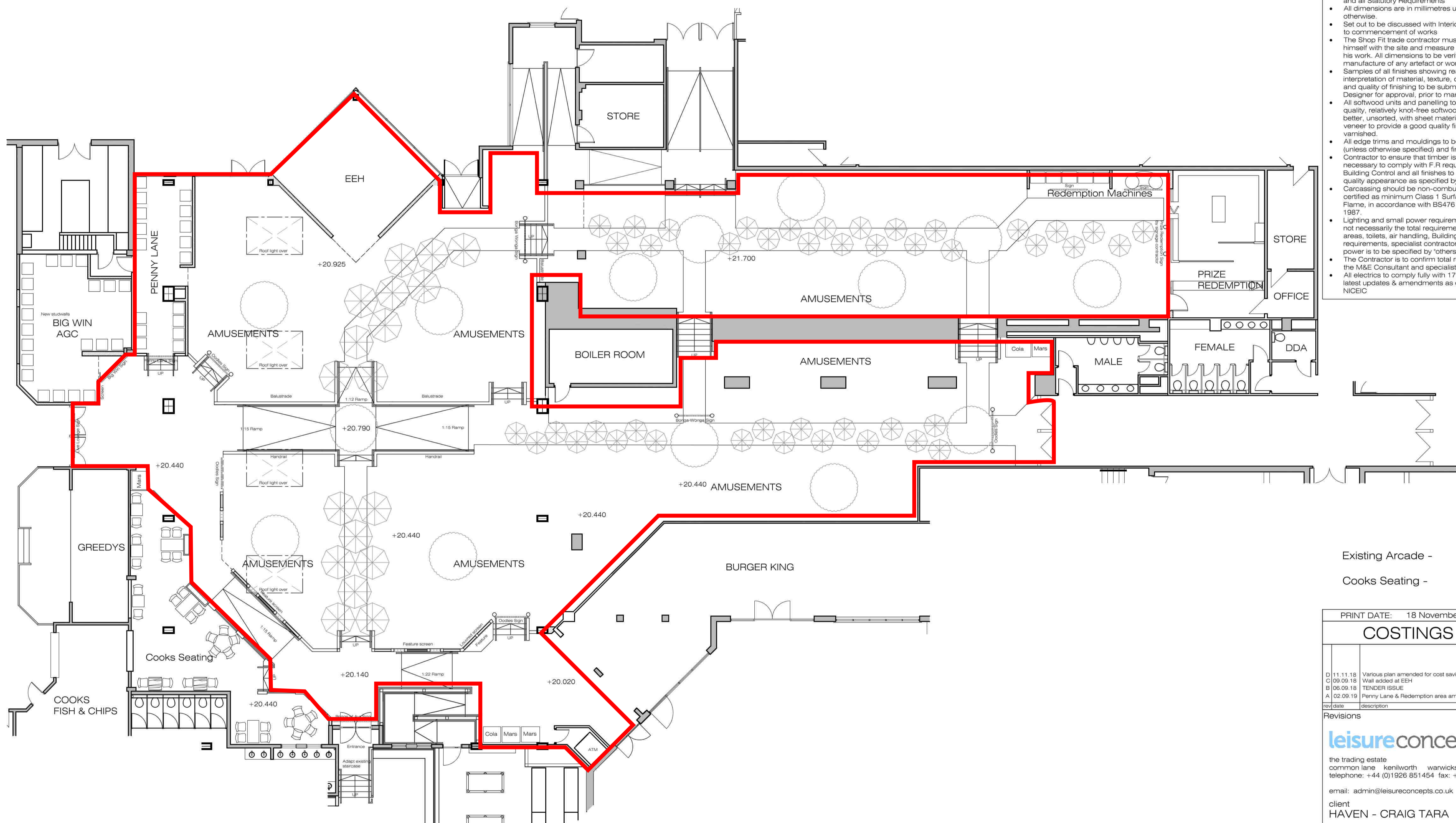

- GENERAL NOTES**
- All Leisure Concepts drawings to be read in conjunction with Architect, Structural Engineer, M&E Consultants and all other specialist contractors/ suppliers drawings.
 - Drawing to be read in conjunction with all other Leisure Concepts drawings for area.
 - All works to be carried out by recommended installation contractors to manufacturers instructions/ recommendations
 - All work should comply with BS Codes of Practice and all Statutory Requirements
 - All dimensions are in millimetres unless stated otherwise.
 - Set out to be discussed with Interior Designer prior to commencement of works
 - The Shop Fit trade contractor must familiarise himself with the site and measure all areas affecting his work. All dimensions to be verified on site prior to manufacture of any artefact or works, on or off site.
 - Samples of all finishes showing realistic interpretation of material, texture, colour, reflectivity and quality of finishing to be submitted to the Designer for approval, prior to manufacture.
 - All softwood units and panelling to be in good quality, relatively knot-free softwood, clear and better, unsorted, with sheet materials faced in veneer to provide a good quality finish when varnished.
 - All edge trims and mouldings to be in solid wood (unless otherwise specified) and finished to match.
 - Contractor to ensure that timber is Pre-treated as necessary to comply with F.R requirements of Building Control and all finishes to achieve good quality appearance as specified by architect.
 - Carcassing should be non-combustible or be certified as minimum Class 1 Surface Spread of Flame, in accordance with BS476 Part 7 1971 or 1987.
 - Lighting and small power requirements shown are not necessarily the total requirements. Service areas, toilets, air handling, Building Regs requirements, specialist contractors items e.g stage power is to be specified by others.
 - The Contractor is to confirm total requirements with the M&E Consultant and specialist contractors.
 - All electrics to comply fully with 17th Edition and latest updates & amendments as determined by NICEIC

Existing Arcade - 1390m²
 Cooks Seating - 65m²

PRINT DATE: 18 November 2019

COSTINGS		
rev	date	description
D	11.11.18	Various plan amended for cost savings
C	09.09.18	Wall added at EEH
B	06.09.18	TENDER ISSUE
A	02.09.19	Penny Lane & Redemption area amended

Revisions



the trading estate
 common lane kenilworth warwickshire CV8 2EL
 telephone: +44 (0)1926 851454 fax: +44 (0)1926 851776

email: admin@leisureconcepts.co.uk
 client
 HAVEN - CRAIG TARA
 project
 Arcade Refurbishment

title
 Proposed GA & Furniture Plan
 scale
 1:100@A1
 date
 August 2019
 drawn by
 BH
 drawing no
 2338.3.01D

© this drawing and all the information herein is copyright and remains the property of leisure concepts and any breach of this copyright will be prosecuted. wherever figured dimensions are given they are to be accepted in preference to scaled sizes. the contractors are responsible for verifying all dimensions shown hereon before putting any affected work in hand.